

Forest Service Crazy Mountains Maps showing Porcupine Lowline Trail System 1925-1991

Trail system existing prior to Zimmerman/Guths purchasing their land in the 1950s; and the Park County N. Fork of Elk Creek Road and Daisy Dean Roads leading into the Forest Service.

1925

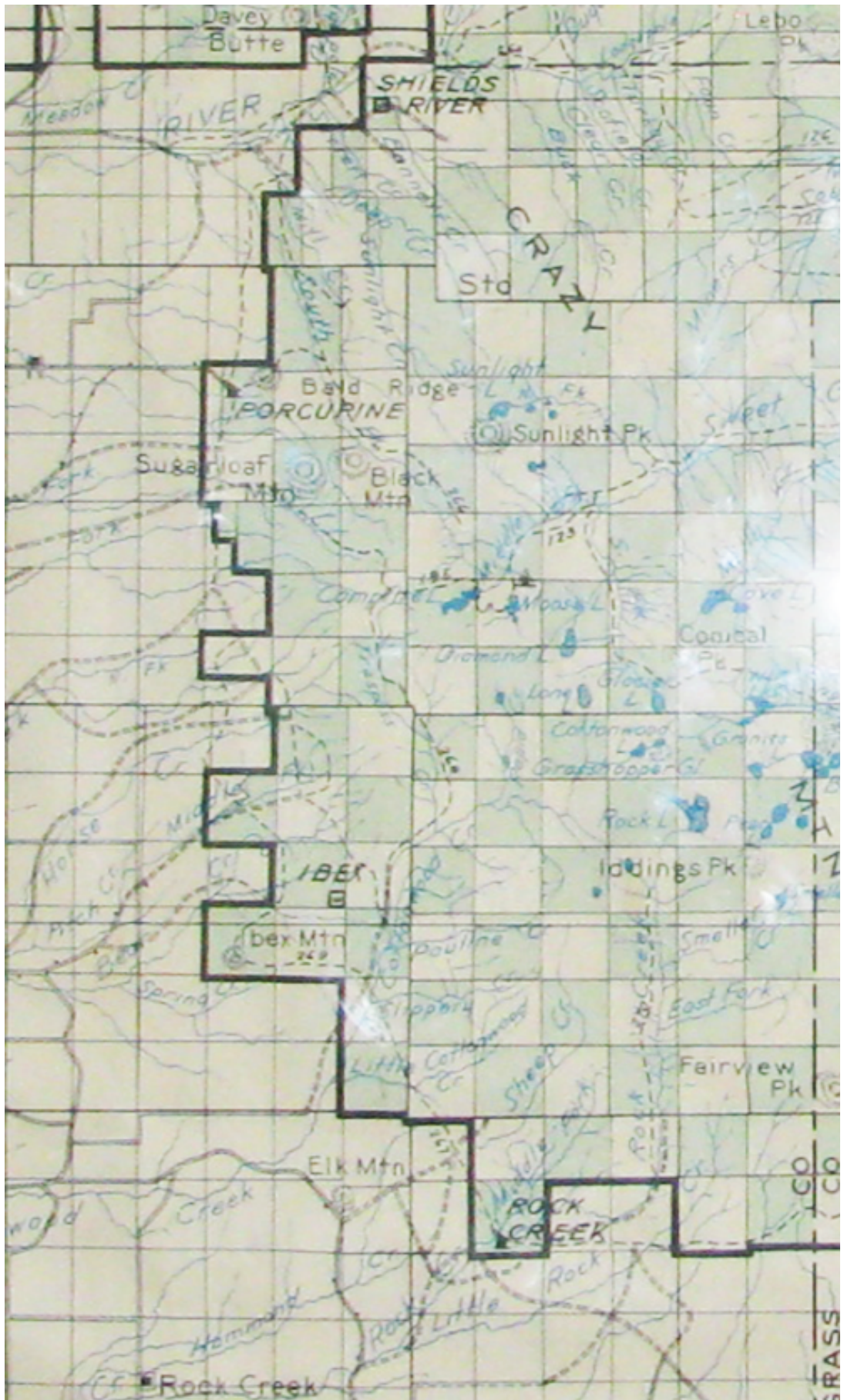



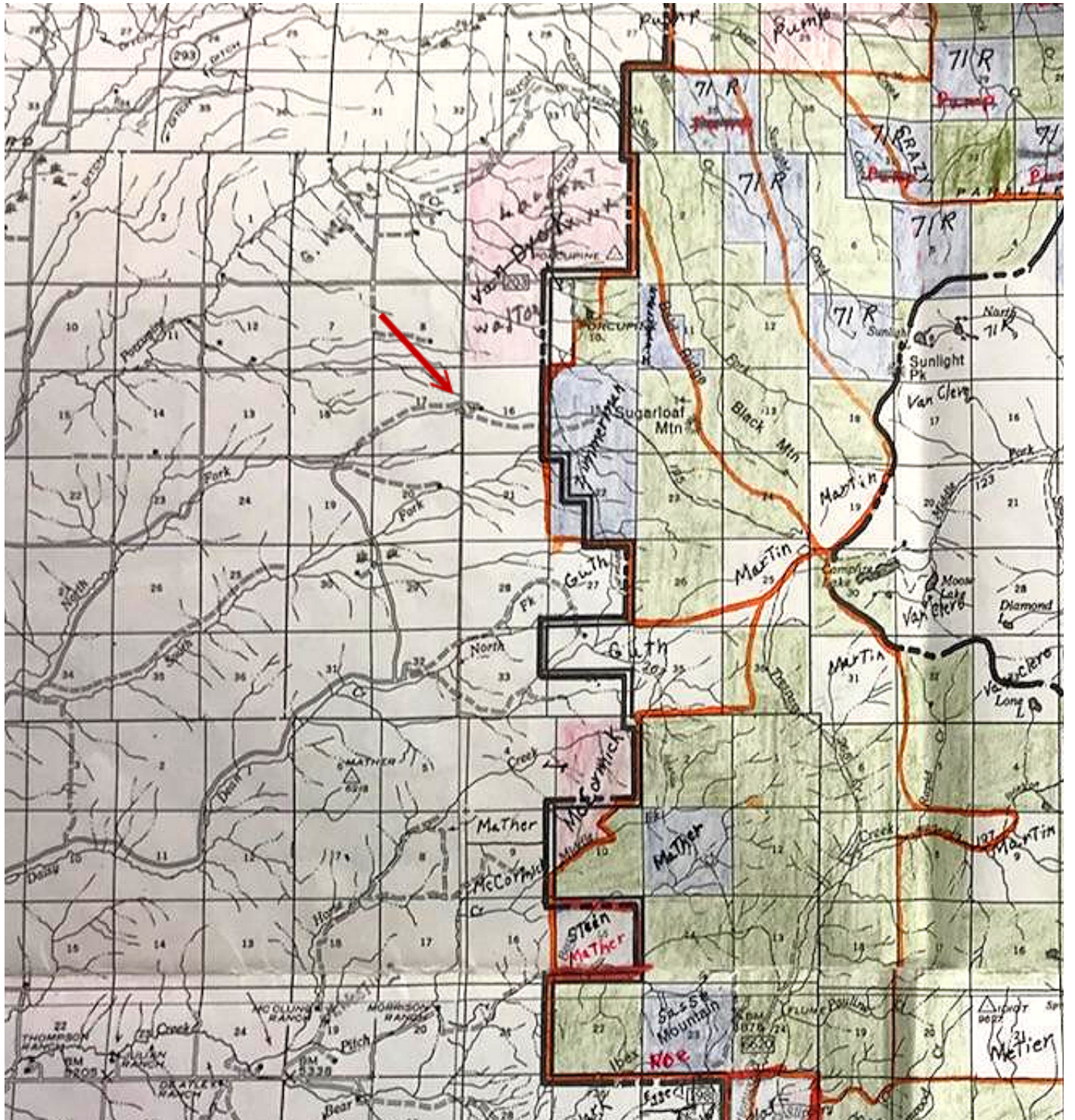

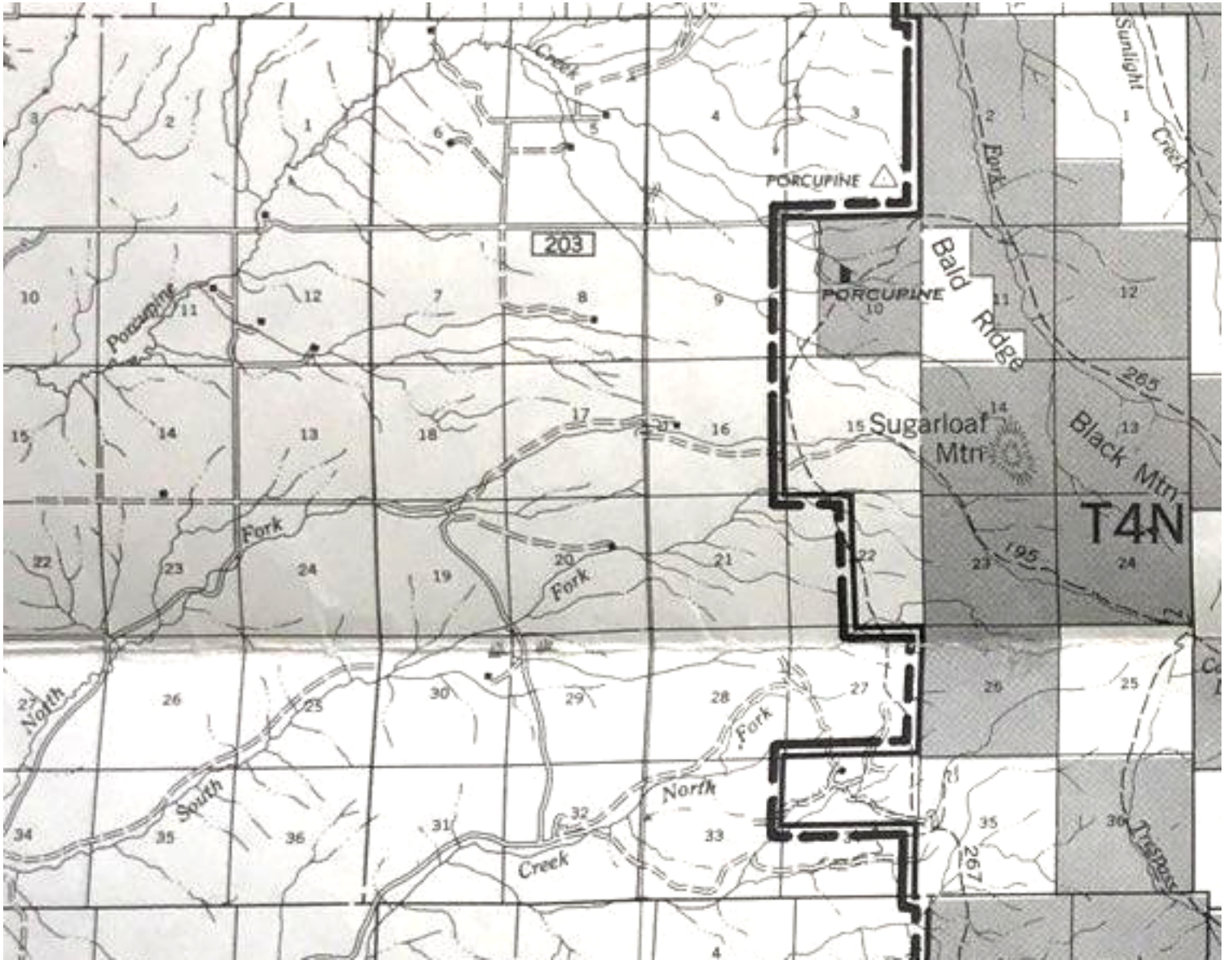

1984 with 1991 Revisions

